

Home & Land Package

Crystele
HOMES



0411278102
LESTER HOPMAN

lester@crystelehomes.com.au



Lot 515

Yabunaru Rd
Austral, NSW 2179

Fixed Price
\$1,107,200

NOTTINGHAM MK2

Purposefully designed for 8.5m frontage lots, the Nottingham caters to all lifestyles. With the living rooms existing on the ground floor, the Nottingham allows you the space to entertain and socialise, whilst keeping your bedrooms a private oasis on the first floor. Offering four bedrooms, two bathrooms and a single garage, the Nottingham is the ultimate family home.

Inclusions

- FIXED SITE COSTS
- BASIX
- Plain concrete driveway up to 30m² – excludes footpath
- Actron single phase ducted air-conditioning unit
- 2590mm high ceilings to ground floor only
- Full height tiling to Bathroom and Ensuite only
- Creative Collection Range - 20mm Stone to Kitchen
- Creative Collection range of glazed porcelain tiles to wet area floors
- Creative Collection range of glazed porcelain tiles to ground main floors OR 8mm Laminate to ground main floors
- 1500mm Freestanding Bath
- Tapware in Matte Black to Bathroom, Ensuite and Powder Room (House Design Specific)

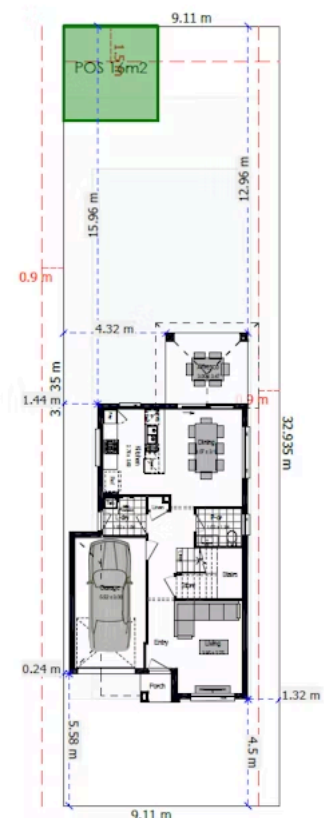

Lot 515



Land Area	300.0 m ²
Ground Floor	65.25 m ²
First Floor	73.63 m ²
Total	171.0 m ²

Garage	18.8 m ²
Porch	1.58 m ²
	m ²

NOTTINGHAM MK2



Yabunaru Rd Austral, NSW 2179

0411278102

LESTER HOPMAN

lester@crystelehomes.com.au

All photographs, Facades, colour schemes, floor plans and dimensions are for illustrative purposes only and may vary slightly to the end product. Prices are based on Crystele Homes "Creative Collection" specifications. Crystele homes reserves the right to change prices without notice. Additional council fees may be payable. Due to individual estate requirements and council guidelines, some typical lot widths may vary and should be used for a guide only. For further terms and conditions please discuss with your Crystele homes sales consultants.